

Mustang Safes

User manual 'Chemical anchor set'

This anchoring method is only suitable for anchoring into a concrete or stone wall/floor. Check in advance that the wall/floor you are anchoring to is thick enough.

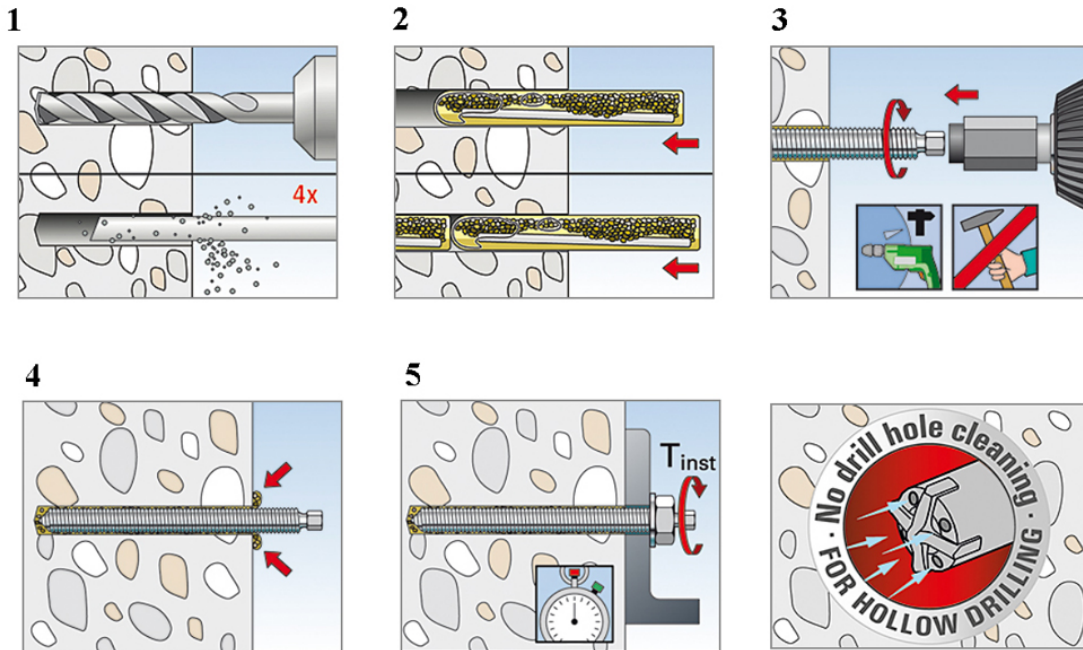

Before you begin installing the chemical anchors, you must determine where the safe will be placed. Once you have the safe in the correct location, you can mark the spot where you need to drill through the safe's anchor holes. Then set the safe aside and follow the steps:

1. Drill the hole, drill hole **diameter 12mm** and drill hole **depth 90mm**.
2. Blow out the hole, the resin capsule (included) must be pushed into the drill hole by hand (be careful not to break the capsule)
3. Only use clean and grease-free anchors. Using a suitable adapter, drive the RG M into the capsule using a hammer drill set on rotary hammer action. Stop when the anchor reaches the bottom of the hole and is set to the correct embedment depth.
4. When fully embedded, excess mortar must emerge from the mouth of the drill Hole.
5. Now wait at least half an hour (at room temperature, at lower temperatures; wait at least an hour) before anchoring the safe.

Now you can put the safe over the anchors, place the supplied washers on the inside of the safe over the anchor, and anchor the safe with the supplied nuts (M10). Check that the safe is firmly anchored and you're done!